

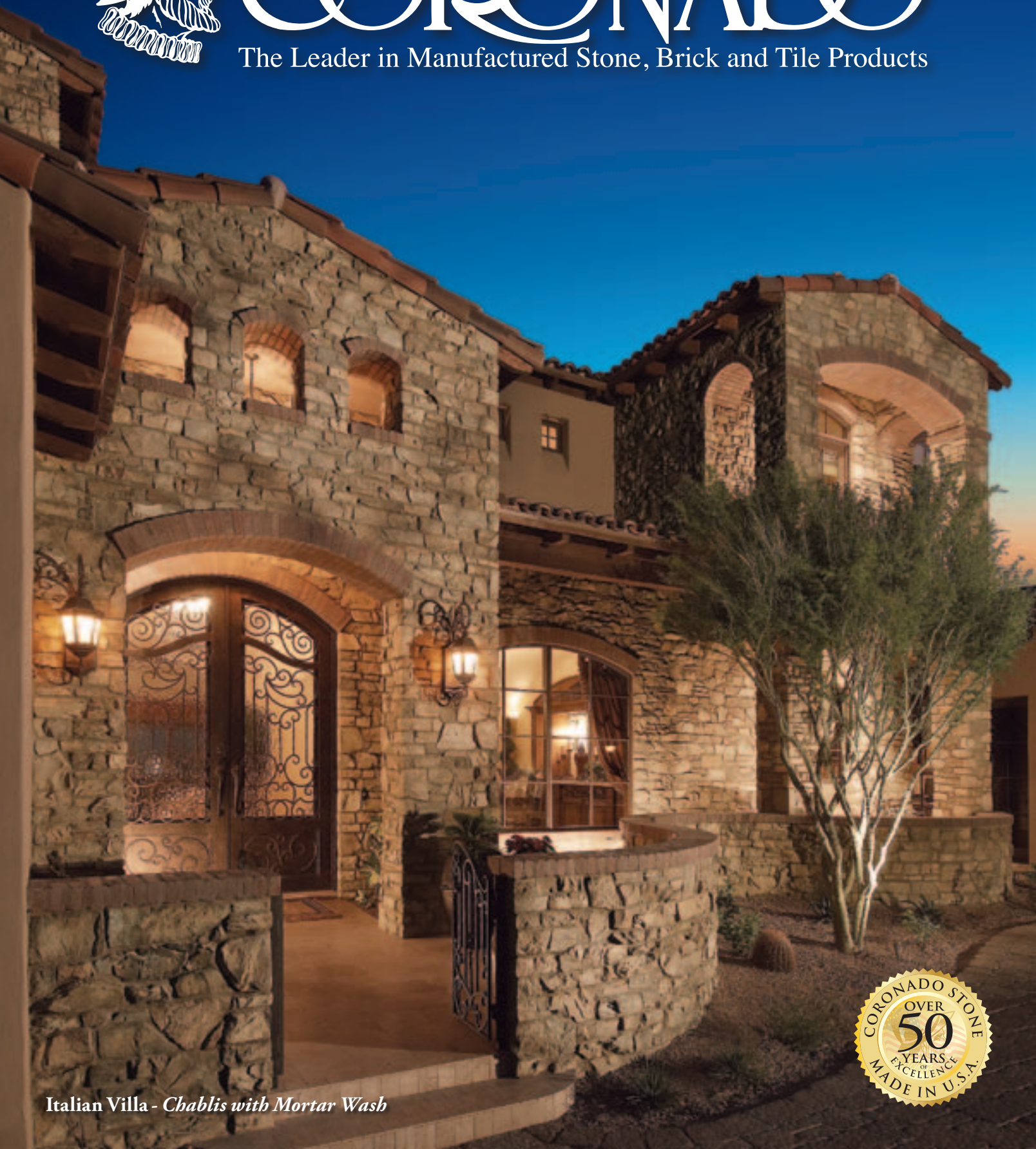

# CORONADO®

The Leader in Manufactured Stone, Brick and Tile Products



*Italian Villa - Chablis with Mortar Wash*

# TABLE OF CONTENTS



Italian Villa®  
Verona



Coronado Honey Ledge  
Golden Harvest



Belgian Castle  
Dakota Brown



8" Classic Jerusalem  
Sabara Beige



The Lennox Stone  
Astoria White



## NEW PRODUCTS

Osage	1
3" Split Limestone	2
Montana Ledge	2
Yukon Rubble	2

## VILLA STONE SERIES

Venetian Villa*	5 - 6
Italian Villa*	7 - 8
Tuscan Villa*	9 - 10
French Country Villa*	11 - 12

## LEDGESTONE SERIES

Old World Ledge	15 - 16
Old Country Ledge	17 - 18
Pro-Ledge*	19 - 20
Coronado Honey Ledge	21 - 22
Quick Stack*	23 - 24
Virginia Ledge	25
Eastern Mountain Ledge*	26 - 28
Rocky Mountain Ledge	29
Canyon Ledge	30
Tumbled Ledge	31
Strip Stones	32
Idaho Drystack	33 - 34
Weathered Edge	35 - 36

## ASHLAR & RUBBLE SERIES

Country Rubble	39 - 40
Carolina Rubble	41 - 42
English Rubble	43 - 44
Santa Barbara	45 - 46
Country Castle	47 - 48
Belgian Castle	49 - 50

## THE CLASSIC SERIES

8" Classic Jerusalem	53
Smooth Limestone	54
French Limestone	55
Chiseled Limestone	56
Colosseum Travertine	57
Aegean Coral	58
The Getty Stone	59
Sand Canyon Flagstone	60

## THE DESIGNER SERIES

The Lennox Stone	63
The Wave	64
Playa Vista Limestone	65 - 66



Appalachian Fieldstone  
Mountain Sunset



Wirecut Brick  
Old Chicago



Jerusalem Cobble  
Antique Sands

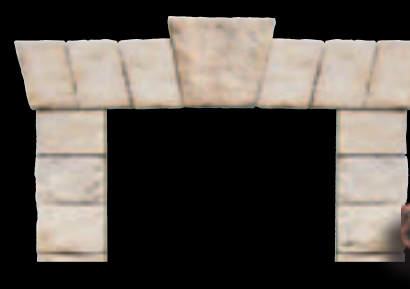

Window Stones  
Buff



Chiseled Wall Cap  
Brownstone



Technical Data

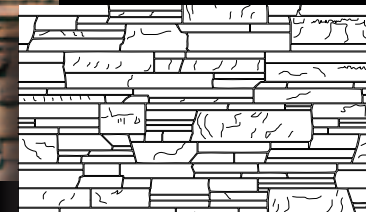

# TABLE OF CONTENTS

## IRREGULAR SHAPED STONE SERIES

Minnesota Fieldstone	69 - 70
Appalachian Fieldstone	71 - 72
Split Fieldstone	73
Viejo Ranch	74
River Rock	75
Creek Rock	76

## STONE COMBINATIONS

Stone Combinations	79 - 80
--------------------	---------

## THIN BRICK SERIES

Special Used Brick	83 - 84
Clinker Brick	85
Sculptured Brick	86
Sicilian Brick	87
Belgian Brick	87
Wirecut Brick	87 - 88
Adobe Brick	89
Roman Brick	90
Weathered Brick	90
New England Brick	90

## FLOOR TILE SERIES

Versailles Travertine	93
Jerusalem Cobble	93
Italian Tile	94
Mexican Tile	94
Belgian Tile	95
Random Flagstone Tile	95
River Washed Tile	96
European Cobble	96

## TRIM & ACCESSORIES

Moldings, Sills, Lintels & Mantels	99
Window Stones, Trim Stones, Hearthstones & Boxes	100
Quoins, Wall Caps & Post Caps	101
Brick Accessories	102

## TECHNICAL DATA

Grouting Options	105 - 106
Profile - Standard Colors & Sizes	107 - 108
Technical Data	109
Project Image Credits	109
Limited Warranty	110
Building Green Information	111 - 112

Coronado Stone has been the leading innovator in the manufactured stone industry for over fifty years. We have replicated some of the most sought after natural stone varieties in the world and we continue to add new products year after year. We are dedicated to offering an extensive product line with unique textures and colors that can be used to enhance any architectural style.

Our manufactured stone is engineered to be both realistic and efficient. We use time-tested craftsmanship to imitate the look and feel of natural stone. We also engineer the shapes and sizes of our profiles to minimize installation time and maximize the stone's inherent beauty. Each of our stone profiles feature a unique blend of textures and colors that mimic the distinct characteristics of the native stones they replicate.



3" Split Limestone - *Genoa Sands*



Osage - *Ancient Reef*



Montana Ledge - *Chablis*



Osage - *Fossil Bay*



Yukon Rubble - *Black Rundle*



## VILLA STONE SERIES

We searched up and down the Mediterranean coast to find the perfect blend of stone shapes and textures that embodied European old world architecture. Our Villa Stone profiles exemplify the unique characteristics of some of the most sought after types of stone adorning villas and chateaus across Europe.

*Italian Villa® - Verona*  
*Tuscan Villa® - Florentine*



Venetian Villa® - *Sunset Blend*



Venetian Villa® - *Madison County*



Venetian Villa® - *Dakota Brown*



Venetian Villa® - *Sunset Blend*



Venetian Villa® - *Madison County*



Venetian Villa® - *Versailles*

Square foot coverage is based on installation with a 1/2" mortar joint.  
Other colors are available for this profile.



Italian Villa® - Volterra



Italian Villa® - Verona



Italian Villa® - Verona



Italian Villa® - Provo Canyon Grey



Italian Villa® - Dakota Brown



Italian Villa® - Volterra



Italian Villa® - Portabella



Italian Villa® - Aspen



Tuscan Villa® - Romano



Tuscan Villa® - Florentine



Tuscan Villa® - Florentine



Tuscan Villa® - Prairie Moss



Tuscan Villa® - Romano



Tuscan Villa® - Dakota Brown



*French Country Villa® - Volterra*



*French Country Villa® - Volterra*



*French Country Villa® - Verona*



*French Country Villa® - Grey Quartzite*



*French Country Villa® - Carmel Mountain*



*French Country Villa® - Bordeaux*



*French Country Villa® - Champagne*



*French Country Villa® - Chablis*

Square foot coverage is based on installation with a 1/2" mortar joint.  
Other colors are available for this profile.





## *LEDGESTONE SERIES*

We feature a vast selection of ledgestone profiles which replicate some of the most beautiful quarried ledgestones from around the country. Choose from a wide array of shapes, sizes and colors to compliment any architectural project, ranging from rustic to contemporary in style.

*Weathered Edge - Coal Canyon*



Old World Ledge - Grey Quartzite (Stacked)



Old World Ledge - Carmel Mountain (Stacked)



Old World Ledge - Antique Cream (Stacked)



Old World Ledge - Burnt Oak (Stacked)



Old World Ledge - Monarch (Stacked)



Old World Ledge - Brookside (Grouted)



Old World Ledge - Summerlin Blend (Stacked)



Old World Ledge - Chablis (Stacked)

Square foot coverage is based on installation with a 1/2" mortar joint.  
Other colors are available for this profile.



Old Country Ledge - *Burnt Oak (Stacked)*



Old Country Ledge - *Shasta (Stacked)*



Old Country Ledge - *Madison County (Grouted)*



Old Country Ledge - *Carmel Mountain (Grouted)*



Old Country Ledge - *Carmel Mountain (Grouted)*



Old Country Ledge - *Chablis (Stacked)*



Old Country Ledge - *Dakota Brown (Stacked)*



Old Country Ledge - *Coastal Brown (Grouted)*



Old Country Ledge - *Aspen (Grouted)*



Old Country Ledge - *Greycliffe (Stacked)*

Square foot coverage is based on installation with a 1/2" mortar joint.  
Other colors are available for this profile.



Pro-Ledge® - *Black Forest*



Pro-Ledge® - *White*



Pro-Ledge® - *Alaskan Sunset*



Pro-Ledge® - *Brookside*



Pro-Ledge® - *Black Forest*



Pro-Ledge® - *Dakota Brown*



Pro-Ledge® - *Chablis*



Pro-Ledge® - *Brookside*



Coronado Honey Ledge - *Golden Harvest*



Coronado Honey Ledge - *Shasta*



Coronado Honey Ledge - *Four Rivers*



Coronado Honey Ledge - *Carmel Mountain*



Coronado Honey Ledge - *Grey Quartzite*



Coronado Honey Ledge - *Chablis*



Coronado Honey Ledge - *Golden Harvest*



Coronado Honey Ledge - *Rocky Mtn. Rundle*



Coronado Honey Ledge - *Carmel Mountain*



Coronado Honey Ledge - *Sioux Falls*



Quick Stack® - Carmel Mountain



Quick Stack® - *Antique Cream*



Quick Stack® - *Carmel Mountain*



Quick Stack® - *Cape Cod Grey*



Quick Stack® - *Aspen*



Quick Stack® - *Cathedral Grey*



Quick Stack® - *Coastal Brown*

Square foot coverage is based on installation with tightly-fitted joints.  
Other colors are available for this profile.



Virginia Ledge - Cape Cod Grey



Virginia Ledge - Golden Sand



Virginia Ledge - Storm Brown



Eastern Mountain Ledge® - Dakota Brown



Virginia Ledge - Coastal Brown



Virginia Ledge - Aspen



Eastern Mountain Ledge® - Dakota Brown



Eastern Mountain Ledge® - Brookside

Square foot coverage is based on installation with tightly-fitted joints.  
Other colors are available for this profile.



Eastern Mountain Ledge® - *Green Valley Quartzite*



Eastern Mountain Ledge® - *Grey Quartzite*



Eastern Mountain Ledge® - *Wheat*



Eastern Mountain Ledge® - *Madison County*



Eastern Mountain Ledge® - *Chestnut*



Eastern Mountain Ledge® - *Carmel Mountain*



Eastern Mountain Ledge® - *Chablis*



Eastern Mountain Ledge® - *Aspen*



Eastern Mountain Ledge® - *Coastal Brown*





Rocky Mountain Ledge - *Sandy Peaks (Stacked)*



Rocky Mountain Ledge - *Meadow Springs (Stacked)*



Rocky Mountain Ledge - *Bitterroot (Grouted)*



Rocky Mountain Ledge - *Greycliffe (Stacked)*



Rocky Mountain Ledge - *Copper Canyon (Stacked)*



Canyon Ledge - *Dakota Brown (Grouted)*



Canyon Ledge - *Cape Cod Grey (Stacked)*



Canyon Ledge - *Sunset Blend (Grouted)*



Canyon Ledge - *Dakota Brown (Stacked)*



Canyon Ledge - *Brookside (Stacked)*



Tumbled Ledge - *Chablis*



Tumbled Ledge - *Sunset Blend*



Tumbled Ledge - *Nottingham*



Tumbled Ledge - *Chablis*



Tumbled Ledge - *Dakota Brown*

## CORONADO STRIP STONE



Coronado Strip Stone - *Fawn*



Coronado Strip Stone - *Fawn*



Coronado Strip Stone - *Black Forest*

## MOUNTAIN STRIP STONE



Mountain Strip Stone - *Renaissance Blend*



Mountain Strip Stone - *Brookside*



Mountain Strip Stone - *Chablis*



Idaho Drystack - Carmel Mountain



Idaho Drystack - Cape Cod Grey



Idaho Drystack - Cape Cod Grey



Idaho Drystack - Antique Buff



Idaho Drystack - Carmel Mountain



Idaho Drystack - Grey Quartzite



Idaho Drystack - Chablis



Idaho Drystack - Aspen

Square foot coverage is based on installation with tightly-fitted joints.  
Other colors are available for this profile.



Weathered Edge - *Chablis*



Weathered Edge - *Sunhill Blend*



Weathered Edge - *Foxhill Blend*



Weathered Edge - *Wisconsin Blend*



Weathered Edge - *Chablis*



Weathered Edge - *Coal Canyon*



Weathered Edge - *Sunhill Blend*



Weathered Edge - *Aspen*



## ASHLAR & RUBBLE SERIES

The skillfully handcrafted stones from this series can be traced back to times when artisan masons meticulously chiseled blocks of limestone to construct majestic structures. These magnificent stone profiles possess wonderfully sculpted textures and can be installed in an ashlar or coursed pattern.

*Carolina Rubble - Sandstone*



Country Rubble - *Madison County (Grouted)*



Country Rubble - *Aspen (Stacked)*



Country Rubble - *Antique Cream (Stacked)*



Country Rubble - *Grey Quartzite (Grouted)*



Country Rubble - *Coastal Brown (Stacked)*



Country Rubble - *Golden Brown (Stacked)*



Country Rubble - *Aspen (Stacked)*



Country Rubble - *Sunset Blend (Stacked)*

Square foot coverage is based on installation with a 1/2" mortar joint.  
Other colors are available for this profile.



Carolina Rubble - *Dakota Brown*



Carolina Rubble - *Sandstone*



Carolina Rubble - *Aspen*



Carolina Rubble - *Dakota Brown*



Carolina Rubble - *Sandstone*



Carolina Rubble - *Grey Quartzite*

Square foot coverage is based on installation with a 1/2" mortar joint.  
Other colors are available for this profile.



English Rubble - *Dakota Brown*

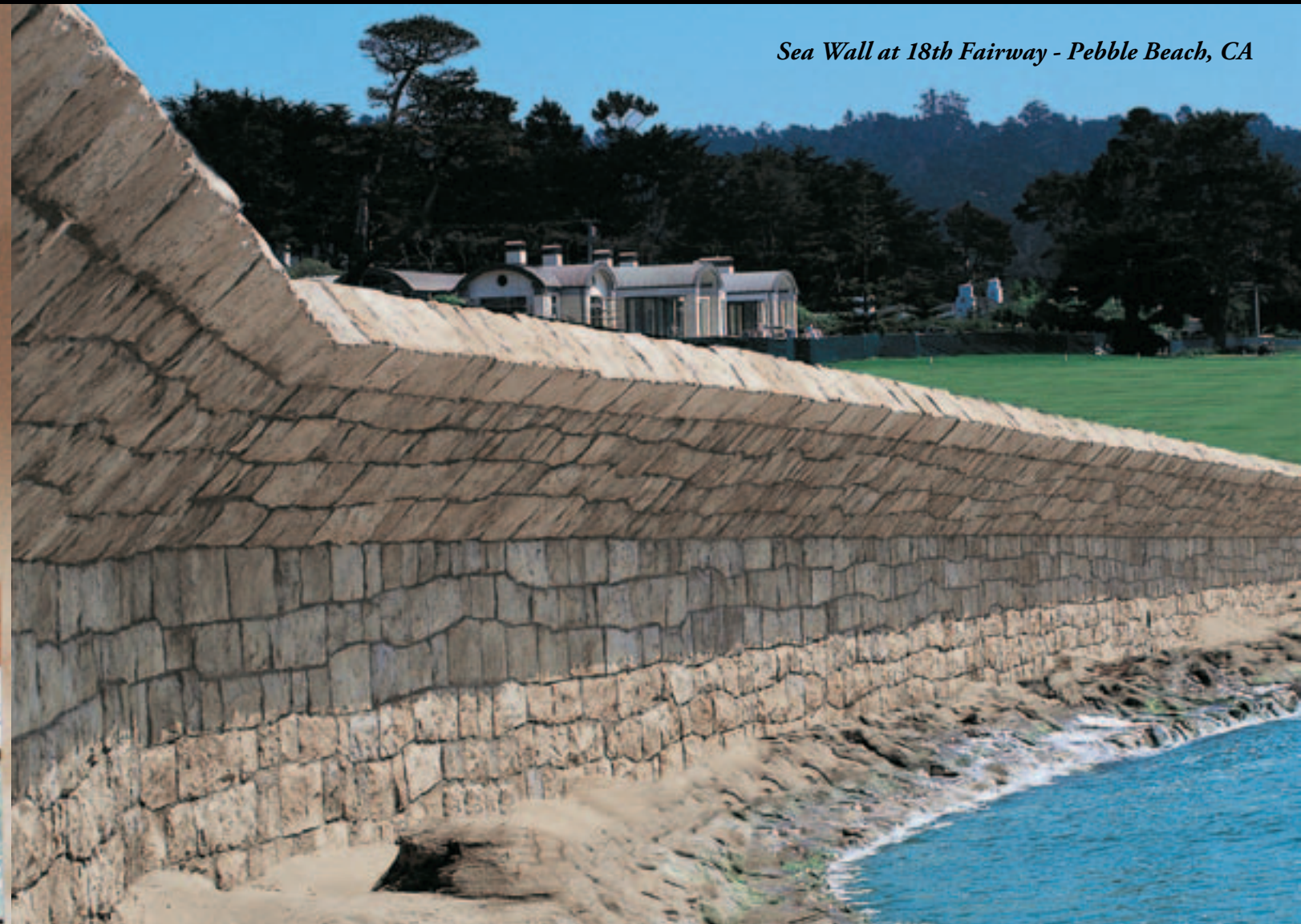

*Sea Wall at 18th Fairway - Pebble Beach, CA*

English Rubble - *Pebble Beach Blend*



English Rubble - *Newport Sandstone*



English Rubble - *Black Hills*

Square foot coverage is based on installation with a 1/2" mortar joint.  
Other colors are available for this profile.





Santa Barbara - Sand Dune (Coursed Pattern)



Santa Barbara - Brookshire (Ashlar Pattern)



Santa Barbara - Brookshire (Ashlar Pattern)



Santa Barbara - Sand Dune (Ashlar Pattern)

Square foot coverage is based on installation with a 1/2" mortar joint.  
Other colors are available for this profile.



Country Castle - Lompoc



Country Castle - Madison County



Country Castle - Madison County



Country Castle - Dakota Brown



Country Castle - Grey



Country Castle - Redwood



Country Castle - Sunset Blend



Country Castle - Chablis

Square foot coverage is based on installation with a 1/2" mortar joint.  
Other colors are available for this profile.



Belgian Castle - *Light Grey (Stacked)*



Belgian Castle - *Dakota Brown (Grouted)*



Belgian Castle - *Chablis (Grouted)*



Belgian Castle - *Brookside (Stacked)*



Belgian Castle - *Sunset Blend (Stacked)*



Belgian Castle - *Dakota Brown (Stacked)*



## *THE CLASSIC SERIES*

These alluring oversized tiles were created to mimic the elegant stone adorning some of the most stunning architectural wonders of the world. The exquisite textures included in this series range from finely detailed limestone to deeply eroded travertine. Each profile flows well with both Classical and Modern design styles.

12" x 24" Chiseled Limestone - *Cream*  
12" x 24" French Limestone - *French White*  
16" x 24" Colosseum Travertine - *Harvard Grey*  
Bella Terra Sill - *Cream*



8" Classic Jerusalem - Sahara Beige



Smooth Limestone - French White



8" Classic Jerusalem - Sahara Beige

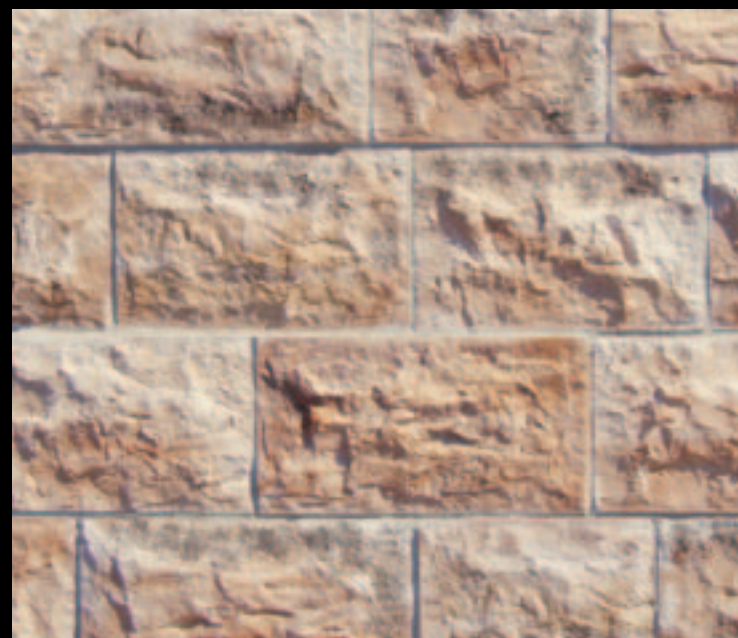

8" Classic Jerusalem - Cayenne



Smooth Limestone - Cream



Smooth Limestone - Harvard Grey



French Limestone with 4" Chiseled Limestone Band - *Country Beige*



Chiseled Limestone - *Sunriver Blend*



French Limestone - *French White*



French Limestone - *Country Beige*



Chiseled Limestone - *Cream*

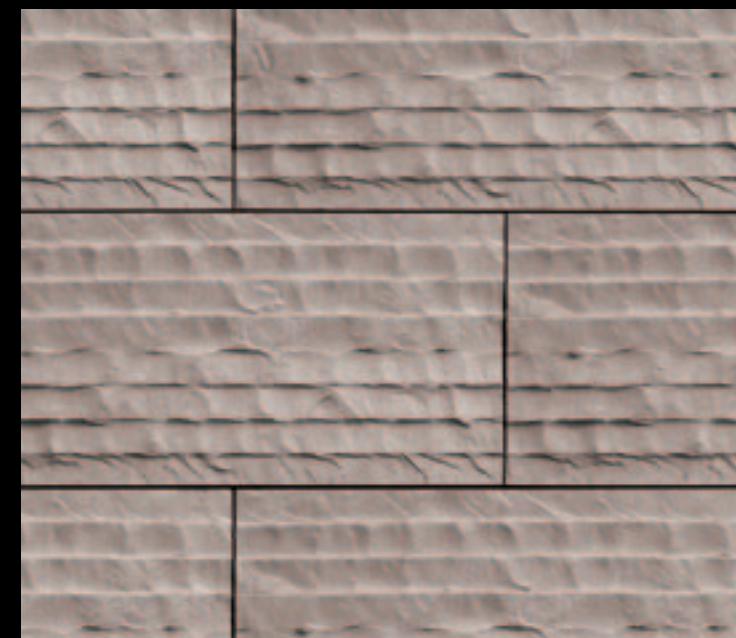

Chiseled Limestone - *Silver Ash*

Square foot coverage is based on installation with a 1/4" mortar joint.  
Other colors are available for this profile.

Square foot coverage is based on installation with a 1/4" mortar joint.  
Other colors are available for this profile.



Colosseum Travertine with 6" Chiseled Limestone Band - *Roman*



Aegean Coral - *Santorini Blend*



Colosseum Travertine - *Roman*



Colosseum Travertine - *Black Forest*



Caribbean Coral - *Barbados (Ashlar Pattern)*



Aegean Coral - *Santorini Blend*



The Getty Stone - Embassy Blend



Sand Canyon Flagstone - Amber Glow



The Getty Stone - Embassy Blend

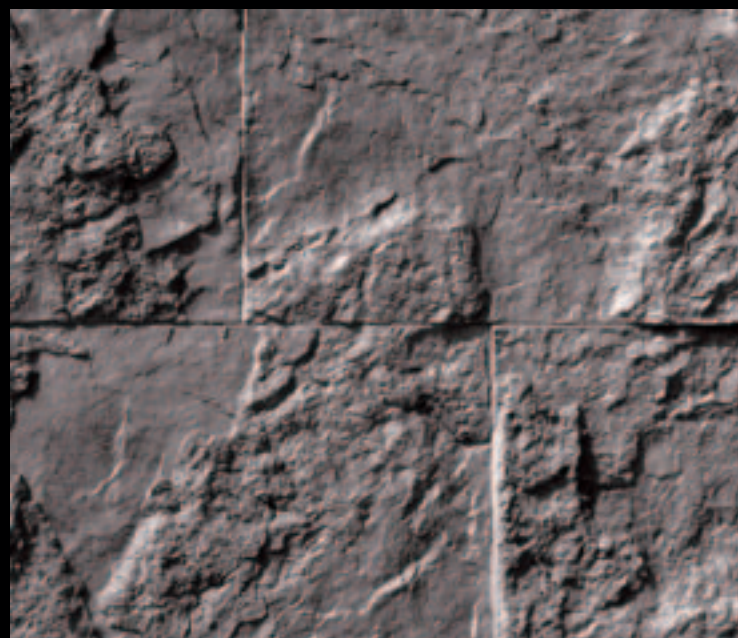

The Getty Stone - Black Forest



Sand Canyon Flagstone - Desert Beige



Sand Canyon Honed - Desert Beige





## *THE DESIGNER SERIES*

This unique series contains a variety of stylish modern profiles. These sleek highly textured veneers were created for the designer looking to add a touch of minimalistic style to their project. The continuous linear patterns compliment both modern and contemporary architectural designs.

The Lennox Stone (Small Sizes) - Astoria White



The Lennox Stone (Large Sizes) - Astoria White



The Wave (Paint Grade)



The Lennox Stone (Large Sizes) - Astoria White



The Wave (Paint Grade)



Playa Vista Limestone - *Alaskan Sunset*



Playa Vista Limestone - *Alaskan Sunset*



Playa Vista Limestone - *Cream*



## *IRREGULAR SHAPED STONE SERIES*

The irregular shaped stones shown in this series replicate a diverse group of fieldstones and river rocks that are native to the Eastern United States. These stones feature textures forged by millions of years of erosion, and a color palette of rich earthy hues that blend seamlessly with outdoor environments.

*Appalachian Fieldstone - Bourbon*



90% Minnesota Fieldstone / 10% Eastern Mountain Ledge - *Wheat*



Minnesota Fieldstone - *Carmel Mountain*



Minnesota Fieldstone - *Dakota Brown*



Minnesota Fieldstone - *Carmel Mountain*



Minnesota Fieldstone - *Aspen*



Minnesota Fieldstone - *Wisconsin Blend*



Minnesota Fieldstone - *Chablis*



Minnesota Fieldstone - *Coastal Brown*

Square foot coverage is based on installation with a 1/2" mortar joint.  
Other colors are available for this profile.



Appalachian Fieldstone - *Mountain Sunset*



Appalachian Fieldstone - *Grey Quartzite*



Appalachian Fieldstone - *Grey Quartzite*



Appalachian Fieldstone - *Dakota Brown*



Appalachian Fieldstone - *Mountain Sunset*



Appalachian Fieldstone - *Madison County*

Square foot coverage is based on installation with a 1/2" mortar joint.  
Other colors are available for this profile.



Split Fieldstone - *Bordeaux*



Split Fieldstone - *Lompoc*



Split Fieldstone - *Silver Grey*



Viejo Ranch - *Viejo Blend*



Split Fieldstone - *Dakota Brown*



Split Fieldstone - *Carmel Mountain*



Viejo Ranch - *Viejo Blend*

Square foot coverage is based on installation with a 1/2" mortar joint.  
Other colors are available for this profile.

Square foot coverage is based on installation with a 1/2" mortar joint at the back of the stone.  
Other colors are available for this profile.



River Rock - Grey Granite



River Rock - Desert Rust



River Rock - Reno Blend



Creek Rock - Southwest Blend



Creek Rock - Palm Springs Blend



Creek Rock - Calico Sand



River Rock - Grey Granite



River Rock - Sienna Brown



Creek Rock - Southwest Blend



Creek Rock - Apache Brown





## STONE COMBINATIONS

Multiple stone veneer styles and colors can be combined to create a custom appearance. Varying the percentage of each profile allows designers to create drastically different looks, which enables further refinement of the style they're trying to achieve.

70% Eastern Mountain Ledge & 30% Minnesota Fieldstone - *Coastal Brown*



80% Eastern Mountain Ledge - *Dakota Brown*  
20% Appalachian Fieldstone - *Dakota Brown*



80% Eastern Mountain Ledge - *Carmel Mountain*  
20% Split Fieldstone - *Wisconsin Blend*



70% Split Fieldstone - *Lompoc*  
30% Eastern Mountain Ledge - *Lompoc*



50% Eastern Mountain Ledge - *Madison County*  
50% Appalachian Fieldstone - *Madison County*



80% Eastern Mountain Ledge - *Dakota Brown*  
20% Appalachian Fieldstone - *Dakota Brown*



50% Tumbled Ledge - *Grey Quartzite*  
50% Minnesota Fieldstone - *Grey Quartzite*



70% Eastern Mountain Ledge - *Carmel Mountain*  
30% Minnesota Fieldstone - *Wisconsin Blend*



80% Minnesota Fieldstone - *Wheat & Chestnut*  
20% Eastern Mountain Ledge - *Wheat & Chestnut*



## THIN BRICK SERIES

We offer a range of thin brick products that come in a wide variety of sizes, textures and colors. Projects can be enhanced with the alluring look and feel of full bed-depth brick, without the need for additional wall tie support that standard brick installations require.

Special Used Brick - *Eagle Buff*



2 1/2" x 8" Special Used Brick - *Eagle Buff*



2 1/2" x 8" Special Used Brick - *Country*



2 1/2" x 8" Special Used Brick - *Country*



2 1/2" x 8" Special Used Brick - *Tribeca*



2 1/2" x 8" Special Used Brick - *Eagle Buff*



2 1/2" x 8" Special Used Brick - *Rustic Blend*



2 1/2" x 8" Clinker Brick - *Antique Red*



2 1/2" x 8" Sculptured Brick - *Eagle Buff*



2 1/2" x 8" Clinker Brick - *Brown Blend*



2 1/2" x 8" Clinker Brick - *Antique Red*



2 1/2" x 8" Sculptured Brick - *Rustic Blend*



2 1/2" x 8" Sculptured Brick - *Wheat*

Square foot coverage is based on installation with a 1/2" mortar joint.  
Other colors are available for this profile.

Square foot coverage is based on installation with a 1/2" mortar joint.  
Other colors are available for this profile.

WIRECUT BRICK



2 1/2" x 8" Wirecut Brick - *La Jolla Blend*



2 1/2" x 8" Wirecut Brick - *Spectrum*

SICILIAN BRICK



2 1/2" x 8" Sicilian Brick - *Marsala Blend*



2 1/2" x 8" Sicilian Brick - *Ferrara Blend*

BELGIAN BRICK



2 1/2" x 8" Belgian Brick - *Bear Creek*



2 1/2" x 8" Belgian Brick - *Brookside*



4" x 12" Wirecut Brick - *Old Chicago*



4" x 12" Wirecut Brick - *Country*



4" x 12" Wirecut Brick - *Old Chicago*

# 4" x 16" ADOBE BRICK



# OVERSIZED THIN BRICK



4" x 16" Adobe Brick - *Sienna with Mortar Wash*

## ROMAN BRICK



2 1/4" x 10" Roman Brick - *Sorano*



2 1/4" x 10" Roman Brick - *Mezzano*

## WEATHERED BRICK



3" x 10" Weathered Brick - *Antique Red*



3" x 10" Weathered Brick - *Carmel Mountain*

## NEW ENGLAND BRICK



3" x 10" New England Brick - *Charleston*



3" x 10" New England Brick - *Dakota Brown*



4" x 16" Adobe Brick - *Saltillo*



4" x 16" Adobe Brick - *Haystack*



## *FLOOR TILE SERIES*

We have gathered some of the most unique flooring textures from around the world to create a beautiful collection of cement-set concrete tiles. Using a specialized method for color blending, the finished product is virtually indistinguishable from natural stone tile.

*Jerusalem Cobble - Antique Sands*  
*Mountain Strip Stone - Fawn*  
*Elephant Ear Wall Cap - Fawn*



# VERSAILLES TRAVERTINE

Versailles Travertine adds a beauty to your home that inspires absolute refinement. From its soft hues to its distinct tumbled textures, Versailles Travertine defines elegance.



Versailles Travertine - *Wheatfield*



Italian Tile - *Saltillo*

# ITALIAN TILE

Italian Tile adds a sense of tradition, warmth and old world charm that other tiles don't possess. This faintly textured tile, coupled with its hard-lined edge, creates a feel of natural symmetry.

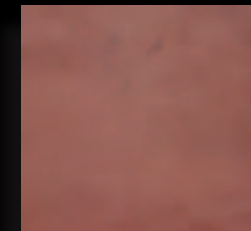

*Mission Red*



*Buckskin*



*Cayenne*

# JERUSALEM COBBLE

Jerusalem Cobble brings the ancient world to your footsteps. Replicating the old cobble roads of Jerusalem with highly detailed textures and rustic earth tone colors, Jerusalem Cobble adds an old world feel to any setting.



Jerusalem Cobble - *Antique Sands*



Mexican Tile - *Milano*

# MEXICAN TILE

Our Mexican Tile is popular throughout the Southwest due to its genuine look and feel. This tile is for those seeking the authentic beauty and style of a Spanish Hacienda.



*Saltillo*



*Burnt Orange*



*Heritage Blend*

# BELGIAN TILE

It is the beauty of Belgian Tile that gives it so much charm. This attractive tile can be used in several different indoor and outdoor settings.



*Antique Buff*

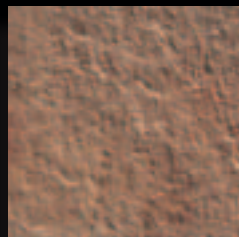

*Rustic Brown*



*Belgian Tile - Autumn Leaves*



*River Washed Tile - Desert Rust*

# RIVER WASHED TILE

River Washed Tile exudes a sense of tranquility. This lightly textured stone mimics natural color blends and works perfectly with indoor and outdoor mosaics.



*Desert Rust*



*Grey Granite*

# RANDOM FLAGSTONE TILE

Random Flagstone has a timeless beauty. This uniquely shaped tile will match almost any architecture and stone veneer. In addition, the shape makes it extremely easy to install.



*Dakota Brown*



*Brookside*



*Grey*



*Random Flagstone Tile - Riviera Blend*



*European Cobble - Alpine Blend*

# EUROPEAN COBBLE

European Cobble radiates the charm and ambience of Europe with an array of old world colors. This profile adds the authentic touch and feel of an ancient cobble stone street.



*Alpine Blend*



*Monaco Blend*



## TRIM & ACCESSORIES

Coronado Stone offers one of the largest architectural stone accessory product lines in the industry. These meticulously handcrafted accents will add the extra finishing touches to your amazing project.

Flagstone Wall Cap - *Buff*  
Italian Villa® - *Dakota Brown*

MOLDINGS & SILLS

<p><b>Chiseled Stone Sill</b> <i>Brownstone</i></p>  <p>24" 2 1/2" 3"</p>	<p><b>600 Series Sill</b> <i>Brownstone</i></p>  <p>24" 4" 2 1/2" 1"</p>
<p><b>Bella Terra Sill</b> <i>Roman</i></p>  <p>24" 3" 2 1/2" 1 1/4"</p>	<p><b>900 Series Sill</b> <i>Light Grey</i></p>  <p>24" 2 1/2" 1 3/4" 2 1/2"</p>
<p><b>6" Travertine Series Sill</b> <i>Silver Grey</i></p>  <p>24" 6" 3 1/2" 2"</p>	<p><b>500 Series Wainscot or Sill</b> <i>Off White</i></p>  <p>33" Smooth texture only 4" 3" 2"</p>
<p><b>5" Travertine Series Molding</b> <i>Roman</i></p>  <p>24" 5" 3" 2"</p>	<p><b>5" Molding</b> <i>#2 Grey</i></p>  <p>24" Various textures available 5" 3"</p>



Chiseled Stone Sill - Aspen



500 Series Sill - #2 Grey

WINDOW STONES AND KEYSTONE



Chiseled Stone Texture Shown  
Also Available in a Smooth Limestone Texture

6" 8"	6" 8"	12" 8"	6" 10"	6" 8"
Off White (Left Slanted) Thickness: 2"	Light Grey (Straight) Thickness: 2"	Brownstone (Keystone) Thickness: 3"	Off White (Straight) Thickness: 2"	Off White (Right Slanted) Thickness: 2"

ARCHITECTURAL TRIM STONE



Architectural Trim Stone - Brownstone  
Thickness: 1 1/2" \*Outside measurements shown.

**LINTELS**

<p><b>Split Stone Lintel</b> <i>Chablis</i></p>  <p>38" 2 1/2" 6"</p>	<p><b>Split Stone Lintel</b> <i>Brownstone</i></p>  <p>42" 2 1/2" 10"</p>
<p><b>Chiseled Stone Lintel</b> <i>Light Grey</i></p>  <p>40" 2 1/2" 5"</p>	<p><b>Chiseled Stone Lintel</b> <i>Buff</i></p>  <p>40" 5" 5"</p>

\*Can be cut into an L-shape for recessed windows.

Chiseled Stone Lintel - Volterra  
(Above Window)



Split Stone Sill - Volterra (Below Window)

Chiseled Stone Mantel - Carmel Mtn.

**MANTELS**

<p><b>Chiseled Stone Mantel</b> <i>Carmel Mountain</i></p>  <p>54" 7 3/4" 2 3/4"</p>	<p><b>Flagstone Mantel</b> <i>Dakota Brown</i></p>  <p>32" 4 1/2" 2 1/4"</p>
--	--



HEARTHSTONES

18" x 20" x 2" Will accommodate all colors.

			
<i>Aspen</i>	<i>Buff</i>	<i>Carmel Mtn.</i>	<i>Dakota Brown</i>
			
<i>Chablis</i>	<i>Light Grey</i>	<i>Lompoc</i>	<i>Brownstone</i>

BOXES

Will accommodate all colors.

				
15" 9"	10 1/4" 8"	7 3/4" 6 1/4"	8" 6"	4" 4"
Light Box Opening: 4"	Light Box Opening: 4"	Electrical Box Opening: 2 1/2" x 4 1/2"	Dryer Vent Box Opening: 4"	Doorbell / Hose Bib Opening: 1 1/2"

## QUOINS

Thickness: 2"



**Chiseled Quoin - *Desert Sand***  
Model #502  
Will accommodate all colors.

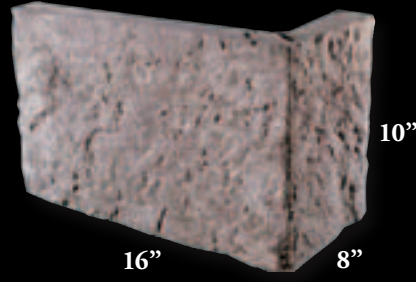

**Belgian Castle Quoin - *Light Grey***  
Model #102  
Will accommodate all colors.

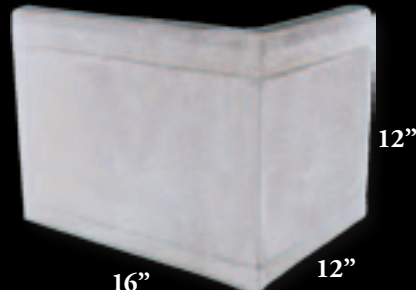

**Vanderbilt Quoin - #2 Grey**  
Colors: Model #402  
#2 Grey, Off White Texture: Drypack

## WALL & POST CAPS



**Flagstone Post Cap - *Lompoc***  
Post Cap Sizes:  
20" x 20", 28" x 28", 30" x 30"



**Flagstone Wall Cap - *Light Grey***  
Wall Cap Sizes:  
9" x 18", 12" x 24", 14" x 24", 18" x 24"

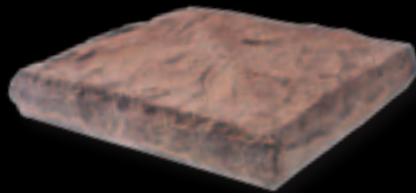

**Chiseled Stone Post Cap - *Brownstone***  
Post Cap Sizes:  
16" x 16", 18" x 18", 20" x 26", 21" x 21"  
24" x 24", 28" x 28", 30" x 30", 32" x 32"  
36" x 36", 38" x 38", 42" x 42"



**Chiseled Stone Wall Cap - *Aspen***  
Wall Cap Sizes:  
8" x 24", 10" x 18", 12" x 18"  
14" x 18", 16" x 24", 18" x 24"

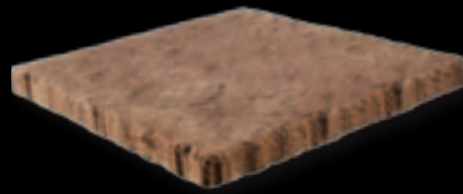

**Snapped Edge Post Cap - *Carmel Mtn.***  
Post Cap Sizes:  
24" x 24"



**Snapped Edge Wall Cap - *Dakota Brown***  
Wall Cap Sizes:  
12" x 24", 14" x 24"



**Pyramid Flagstone Post Cap - *Chablis***  
Post Cap Sizes:  
26" x 26"

Custom Sizes & Colors Available  
For All Wall & Post Caps



## BRICK ACCESSORIES

(All inside measurements are nominal. Items do not come grouted.)



**2 1/2" x 8" Corner  
*Rustic Blend***



**4" x 8" Corner  
*Rustic Blend***

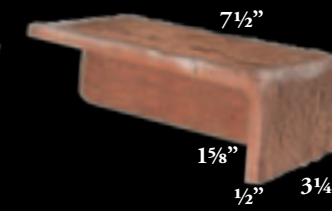

**3-Sided Corner  
*Rustic Blend***  
Left and Right Corners Available



**Long Return Corner  
*Rustic Blend***



**Brick Sill  
*Rustic Blend***



**2 1/2" Brick Molding  
*Rustic Blend***



**4" Brick Molding  
*Antique Red***



**2 1/2" x 10" Brick Cap  
*Tribeca***



**4" x 8" Brick Cap  
*Antique Red***



**Panelized Brick Post Cap  
*Rustic Blend***



**Sawtooth Brick Trim  
*Rustic Blend***

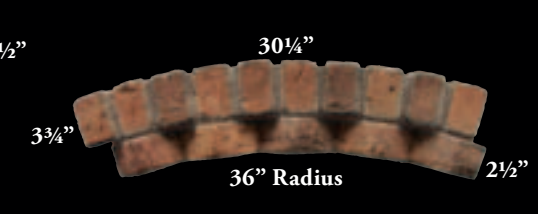

**Panelized Curved Sawtooth  
*Tribeca***



Custom Sizes Available  
For All Brick Accessories

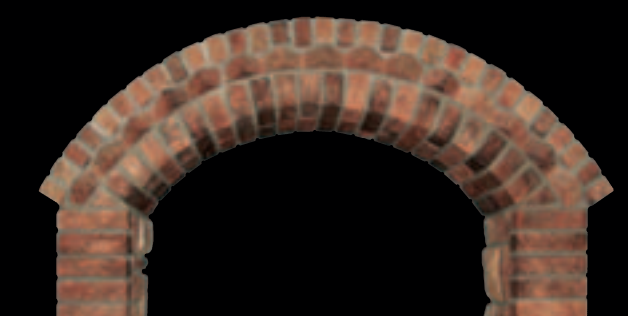

**Panelized Curved Sawtooth Arch - *Tribeca***



## TECHNICAL DATA

Coronado Stone supports the specification and design process with architectural binders, hatch patterns and a variety of other helpful specification tools, all of which are available in hardcopy or can be downloaded from our website.

*Canyon Ledge - Dakota Brown*

*3/4" Full Brushed (White Grout)*



*French Country Villa® - Bordeaux*

*3/4" Full Smooth Brushed (Matching Grout)*



*French Country Villa® - Bordeaux*

*3/4" Full Clean Smooth Brushed*

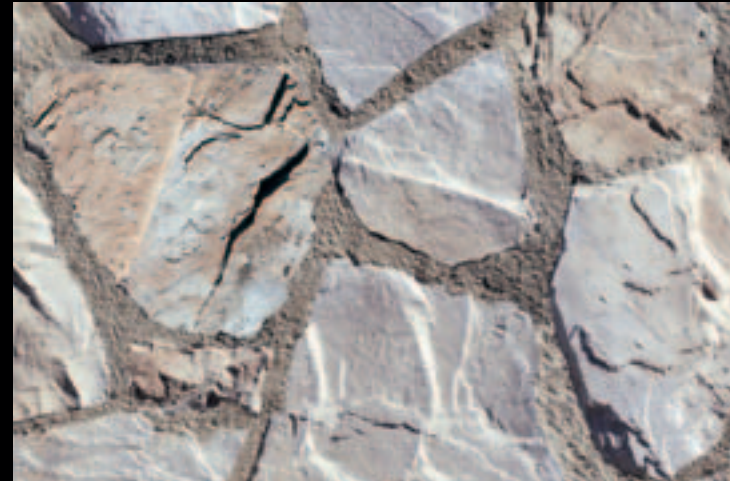

*Euro Villa® - Timberlake*

*1" Full Rough Brushed*



*Euro Villa® - Timberlake*

*1/2" - 3/4" Deep Raked*



*Mountain Villa Stone® - Rustic Valley*

*1" - 1 1/2" Full Smooth Tooled*



*Mountain Villa Stone® - Rustic Valley*

*3/4" Full Brushed*



*Tuscan Villa® - Prairie Moss*

*3/4" Weeping*



*Tuscan Villa® - Prairie Moss*

*3/4" Shallow Brushed*



*Mountain Villa Stone® - Grey Quartzite*

*1" - 1 1/2" Full Brushed*



*Mountain Villa Stone® - Grey Quartzite*

*3/4" Deep Raked (Matching Grout)*



*Italian Villa® - Portabella*

*1" Full Brushed (White Grout)*



*Italian Villa® - Portabella*

Images feature identical stones but different grouting options.

# CORONADO PROFILES - COLOR & SIZES

Profile	Standard Colors	Height	Length	Thickness
<b>3" Split Limestone</b>	Cream, Genoa Sands, Oak and Walnut	3"	up to 18"	1½"
<b>6" Drystack Panel</b>	Carmel Mountain, Chablis, Dakota Brown, Forest Falls, Four Rivers, Grey, Golden Harvest and Shasta	6"*	24"*	1¼"
<b>8" Classic Jerusalem</b>	Cayenne and Sahara Beige	8"	8" - 24"	1"
<b>Adobe Brick</b>	Haystack, Mocha, Peach, Saltillo and Sienna	3½" (±1/8")	15¼" (±1/4")	1"
<b>Aegean Coral</b>	Autumn Blend, Barbados, Cream and Santorini Blend	16"	24"	1"
<b>Appalachian Fieldstone</b>	Bourbon, Carlsbad Blend, Dakota Brown, Grey Quartzite, Madison County and Mountain Sunset	7" - 9"	7" - 9"	1½" - 2½"
<b>Belgian Castle</b>	Bear Creek, Brookside, Chablis, Dakota Brown, Gold Quartzite, Light Grey, Madison County and Sunset Blend	2" - 12"	up to 16"	1"
<b>Belgian Brick</b>	Bear Creek, Brookside, Brown, Gold Quartzite and Light Grey	2½" (±1/16")	7¾" (±1/8")	¾"
<b>Canyon Ledge</b>	Aspen, Brookside, Cape Cod Grey, Chablis, Dakota Brown and Sunset Blend	1" - 7"	up to 20"	1½" - 3"
<b>Caribbean Coral</b>	Autumn Blend, Barbados, Cream and Santorini Blend	4" - 12"	4" - 16"	1"
<b>Carolina Rubble</b>	Aspen, Black Hills, Chablis, Dakota Brown, Grey Quartzite and Sandstone	2" - 10"	4" - 16"	1¼" - 2¼"
<b>Chiseled Limestone</b>	Cream, Lore Ling, Silver Ash and Sunriver Blend	12"	24"	1"
<b>Clinker Brick</b>	Antique Red and Brown Blend	2 ½"	4" and 8"	¾" - 2"
<b>Colosseum Travertine</b>	Black Forest and Roman	16"	24"	1"
<b>Coronado Honey Ledge</b>	Aspen, Carmel Mountain, Chablis, Four Rivers, Golden Harvest, Grey Quartzite, Palomino, Shasta and Sioux Falls	2" - 6"*	up to 20"	1" - 2"
<b>Coronado Strip Stone</b>	Black Forest, Brookside, Fawn, Renaissance Blend and Shasta	1½" - 2"	up to 23"	1¼" to 2"
<b>Country Castle</b>	Antique Cream, Aspen, Chablis, Dakota Brown, Grey, Lompoc, Madison County, Redwood and Sunset Blend	1½" - 7½"	4" - 20"	1½"
<b>Country Rubble</b>	Antique Cream, Aspen, Chablis, Coastal Brown, Dakota Brown, Frontier Blend, Golden Brown, Grey Quartzite, Madison County, Mesa Blend and Sunset Blend	2" - 8"	up to 23"	1" - 2½"
<b>Creek Rock</b>	Apache Brown, Calico Sand, Palm Springs Blend and Southwest Blend	3" - 10"	3" - 10"	¾" - 2½"
<b>Desert Ridge</b>	Aspen, Carmel Mountain, Chablis, Coal Canyon, Sunhill Blend and Wisconsin Blend	1" - 12"	up to 32"	1" - 2½"
<b>Eastern Mountain Ledge®</b>	Antique Cream, Aspen, Brookside, Cape Cod Grey, Carmel Mountain, Chablis, Chestnut, Coastal Brown, Dakota Brown, Green Valley Quartzite, Grey, Grey Quartzite, Lompoc, Madison County and Wheat	1" - 5"	up to 22"	1" - 3"
<b>English Rubble</b>	Black Hills, Cascade Blend, Dakota Brown, Newport Sandstone and Pebble Beach Blend	6" - 14"	8" - 32"	1¼" - 2"
<b>Euro Villa®</b>	Champagne and Timberlake	4" - 12"	Averaging 8"	1" - 1½"
<b>French Country Villa®</b>	Aspen, Bordeaux, Carmel Mountain, Chablis, Provo Canyon Grey, Verona and Versailles	2" - 7"	up to 18"	1½" - 2"
<b>French Limestone</b>	Country Beige and French White	12"	24"	1"
<b>The Getty Stone</b>	Black Forest and Embassy Blend	16"	24"	1" - 1¾"
<b>Idaho Drystack</b>	Antique Buff, Aspen, Brookside, Cape Cod Grey, Carmel Mountain, Chablis, Denver Blend, Grey Quartzite and Smokey Grey	1" - 4"	4" - 16"	1¼" - 2"
<b>Italian Villa®</b>	Aspen, Chablis, Dakota Brown, Portabella, Provo Canyon Grey, Sunset Blend, Verona and Volterra	2" - 8"	up to 16"	1½" - 3¼"
<b>The Lennox Stone</b>	Astoria White and Paint Grade	4" - 16"	4" - 24"	¾" - 2"
<b>Minnesota Fieldstone</b>	Aspen, Burnt Sky, Carmel Mountain, Chablis, Coastal Brown, Dakota Brown, Madison County and Wisconsin Blend	6" - 12"	6" - 12"	1½" - 2½"

# CORONADO PROFILES - COLOR & SIZES

Profile	Standard Colors	Height	Length	Thickness
<b>Montana Ledge</b>	Black Rundle, Carmel Mountain, Chablis and Dakota Brown	1" - 4"*	up to 20"	1" - 2½"
<b>Mountain Strip Stone</b>	Brookside, Carmel Mountain, Chablis, Dakota Brown, Fawn, Four Rivers and Renaissance Blend	1½" and 3"	up to 23"	1¼" to 2"
<b>New England Brick</b>	Charleston, Chesapeake Bay, Dakota Brown and Roxbury	2½" (±1/16")	9½" (±1/8")	½" (±1/16")
<b>Old Country Ledge</b>	Aspen, Burnt Oak, Carmel Mountain, Chablis, Charleston, Coastal Brown, Dakota Brown, Greycliffe, Madison County, Rustic Slate and Shasta	2" - 7"	4" - 20"	1" - 1¾"
<b>Old World Ledge</b>	Antique Cream, Aspen, Brookside, Burnt Oak, Cape Cod Grey, Carmel Mtn., Chablis, Coastal Brown, Dakota Brown, Eucalyptus, Grey Quartzite, Monarch, Summerlin Blend and Sunset Blend	1" - 5"	4" - 16"	1" - 1½"
<b>Osage</b>	Ancient Reef, Fossil Bay	3" - 12"	4" - 28"	1" - 1½"
<b>Playa Vista Limestone</b>	Alaskan Sunset and Cream	2½", 5" and 7¾"	up to 24"	1" - 1½"
<b>Pro-Ledge®</b>	Alaskan Sunset, Black Forest, Brookside, Carmel Mountain, Chablis, Dakota Brown, White, Yuma Blend	4"	up to 24"	1" - 1½"
<b>Quick Stack®</b>	Antique Cream, Aspen, Cape Cod Grey, Carmel Mountain, Cathedral Grey, Coastal Brown, Four Rivers, Grey Quartzite, Rustic Slate and Sahara Blend	2" - 4"*	up to 20"	1½" - 2"
<b>River Rock</b>	Desert Rust, Four Rivers, Grey Granite, Reno Blend, Seaside, Sienna Brown, Vermont Blend and White Granite	4" - 10"	4" - 10"	¾" - 2 ½"
<b>Rocky Mountain Ledge</b>	Bitterroot, Copper Canyon, Greycliffe, Meadow Springs and Sandy Peaks	1" - 6"	up to 18"	1" - 2½"
<b>Roman Brick</b>	Mezzano, Sorano	2½" (±1/8")	9 7/8" (±1/8")	5/8" (±1/16")
<b>Santa Barbara</b>	Brookshire and Sand Dune	6" - 14"	8" - 32"	1¼" - 2"
<b>Sand Canyon Flagstone</b>	Amber Glow, Cream and Desert Beige	16"	30"	1"
<b>Sculptured Brick</b>	Antique Red, Aspen, Rustic Blend and Wheat	2½" (±1/8")	7¾" (±1/4")	¾" - 1"
<b>Sicilian Brick</b>	Ferrara Blend, Marsala Blend and Santa Ana Blend	2½" (±1/8")	7¾" (±1/4")	½" (±1/16")
<b>Smooth Limestone</b>	Cream, French White, Harvard Grey and Off-White	12"	24"	1"
<b>Special Used Brick</b>	Carmel Mountain, Country, Eagle Buff, Red Used, Rustic Blend and Tribeca	2½" (±1/8")	7¾" (±1/4")	½" (±1/16")
<b>Split Fieldstone</b>	Bordeaux, Bouquet Canyon Grey, Carmel Mountain, Dakota Brown, Green Valley Quartzite, Lompoc and Silver Grey	6" - 20"	6" - 20"	1" - 2"
<b>Tumbled Ledge</b>	Aspen, Chablis, Dakota Brown, Madison County, Monterey, Nottingham and Sunset Blend	1" - 4"	4" - 20"	1½" - 3"
<b>Tuscan Villa®</b>	Aspen, Coastal Brown, Dakota Brown, Florentine, Prairie Moss and Romano	2" - 12"	4" - 16"	1" - 1¾"
<b>Venetian Villa®</b>	Antique Cream, Aspen, Chablis, Coastal Brown, Dakota Brown, Frontier Blend, Golden Brown, Grey Quartzite, Madison County, Mesa Blend and Sunset Blend	2" - 14"	4" - 32"	1¼" - 2½"
<b>Viejo Ranch</b>	Viejo Blend	2" - 18"	up to 30"	2" - 3"
<b>Virginia Ledge</b>	Aspen, Cape Cod Grey, Coastal Brown, Golden Sand, Hillside and Storm Brown	2" - 4"*	up to 20"	1" - 3"
<b>The Wave</b>	Paint Grade	32"	32"	½" - 1½"
<b>Weathered Brick</b>	Antique Red, Carmel Mountain and San Vincenzo	2½" (±1/8")	9¾" (±1/8")	½" (±1/16")
<b>Weathered Edge</b>	Aspen, Chablis, Coal Canyon, Foxhill Blend, Sunhill Blend and Wisconsin Blend	1" - 7"	up to 32"	1" - 2½"
<b>Wirecut Brick (Oversized)</b>	Country, La Jolla, Old Chicago and Spectrum	3½" (±1/16")	11 ½" (±1/8")	½" (±1/16")
<b>Wirecut Brick (Standard)</b>	Country, La Jolla, Old Chicago and Spectrum	2½" (±1/16")	7¾" (±1/8")	½" (±1/16")
<b>Yukon Rubble</b>	Black Rundle, Carmel Mountain, Chablis and Dakota Brown	1" - 8"	up to 24"	1" - 2½"

\* Stone sizes within panels may vary. Contact Coronado for further details.

All sizes are nominal and may vary slightly depending on profile. Color blends may vary from region to region depending on local aggregates.



## Index of Typical Installation Types

View [www.Coronado.com](http://www.Coronado.com) for detailed installation instructions

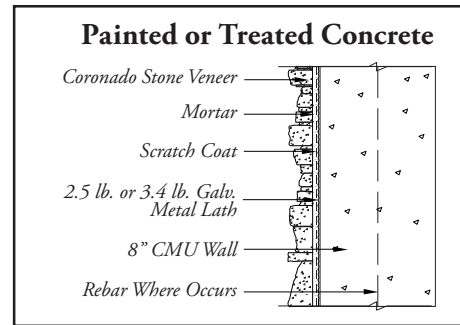
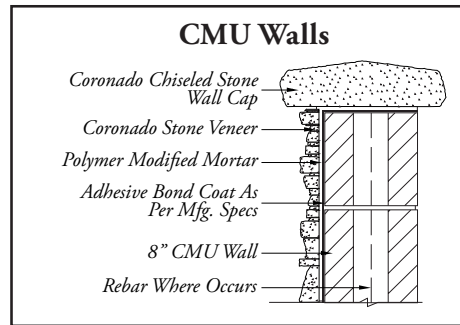
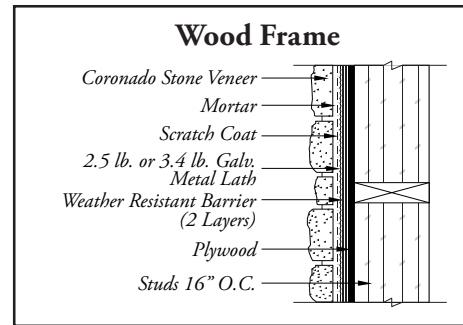

## TECHNICAL DOWNLOADS

Visit [www.Coronado.com](http://www.Coronado.com) to download an extensive collection of technical data and specification sheets. Click on the (ARCHITECTURAL TOOLS) link in the top menu bar to view the following items:

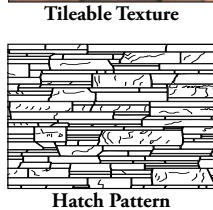

- Installation Specification Sheets
- Technical Data
- Cross-Section Details
- Hatch Patterns
- Stone Tileable Textures

## PROJECT IMAGE CREDITS

Arizona Stone Products, LLC <a href="http://www.arizonastone.com">www.arizonastone.com</a>	Distributor Mesa, AZ	Cover
Calvis Wyant Luxury Homes <a href="http://www.calviswyant.com">www.calviswyant.com</a>	Builder Scottsdale, AZ	Cover
Gina Spiller <a href="http://www.ginaspillerdesign.com">www.ginaspillerdesign.com</a>	Designer Monterey, CA	Cover
Mark Boisclair Photography, Inc. <a href="http://www.markboisclair.com">www.markboisclair.com</a>	Photographer Phoenix, AZ	Cover
Woodley Architectural Group <a href="http://www.woodleyarchitecture.com">www.woodleyarchitecture.com</a>	Architect Santa Ana, CA	Back Cover
Bruno Built Homes <a href="http://www.brunobuilt.com">www.brunobuilt.com</a>	Builder Eagle, ID	110
Castone <a href="http://www.castone.org">www.castone.org</a>	Distributor Knoxville, TN	6,15
EON Design Group <a href="http://www.eondesignco.com">www.eondesignco.com</a>	Designer Los Angeles, CA	77-78
Lee Ann White <a href="http://leeannwhite.com">leeannwhite.com</a>	Photographer GA	67-68
Process Design Build, L.L.C. <a href="http://www.processdesignbuild.com">www.processdesignbuild.com</a>	Builder Tucson, AZ	18, 30, 103-104
Red Rock Contractors <a href="http://www.buildredrock.com">www.buildredrock.com</a>	Builder Mesa, AZ	67-68
Timber Ridge Properties <a href="http://www.timberidgeproperties.net">www.timberidgeproperties.net</a>	Builder Denver, CO	13-14, 43
Veranda Estate Homes <a href="http://www.verandastatehomes.com">www.verandastatehomes.com</a>	Builder Calgary, AB	37-38
Wendy Black Rodgers Interior <a href="http://www.wbrint.com">www.wbrint.com</a>	Interior Designer Scottsdale, AZ	7
Woodley Architectural Group <a href="http://www.woodleyarchitecture.com">www.woodleyarchitecture.com</a>	Architect Santa Ana, CA	55

Coronado Stone is manufactured to meet or exceed specifications for all major code approvals. Independent testing confirms compliance with ICC-ES AC51 for Precast Stone Veneer. Always check your local building codes before installing stone.

### Materials:

- Cement ASTM C150
- Sand ASTM C144 or C33
- Aggregate ASTM C33 or C330

### Testing:

- Shear Bond Test Tested in accordance with ASTM C482 Greater than 50 psi
- Water Absorption Tested in accordance with section 3.1.4 & 4.6 of ICC-ES AC51
- Freeze / Thaw Tested in accordance with ASTM C67 Less than 3% mass loss
- Unit Weight Shipping weight is less than 15 lbs. per sq. ft. Density is determined in accordance with ASTM C567
- Compressive Strength Tested in accordance with ASTM C39 Greater than 1800 psi
- Tensile Strength Tested in accordance with ASTM C190
- Flexural Strength Tested in accordance with ASTM C348

**Weight:** The average packaged weight of Coronado Stone veneer is 8 to 12 lbs. per square foot. Weight varies with thickness.

**Non-combustible:** Testing on Coronado Stone showed zero flame spread and zero smoke development.

**Integral Colors:** Coronado's production process results in a product which maintains a natural stone appearance even after many years of exposure to the elements.

**Approvals:** Coronado Stone has been tested by independent laboratories and has been approved for its intended use by:

 **ICC The International Conference of Building Officials. Report ESR-2598**

## 50 YEAR LIMITED WARRANTY

Coronado Stone Products' wall veneers are protected under this warranty for a period of 50 years from the date purchased, when used on a vertical structure which conforms to local building codes and when installed in accordance with the manufacturer's instructions. Warranty coverage specifically excludes damage resulting from structure settlement and other types of wall movement; contact with paint or chemicals; discoloration due to contaminants; staining, oxidation and water damage.

This warranty covers only manufacturing defects in Coronado Stone Products' wall veneers and is limited to the replacement or repair of defective materials only and does not cover the cost of removal or installation of defective products. This warranty is limited to the original purchaser and is non-transferable to any subsequent owner.



Coronado Stone Products is dedicated to producing a superior manufactured stone veneer with the least amount of impact to our environment. With a combination of internal recycling techniques, products that increase levels of energy performance and 6 strategically placed facilities throughout the U.S. and Canada, Coronado Stone can help you achieve sustainable solutions for LEED requirements.

LEED Credit Category	LEED Points	Intent	Requirements	Coronado Contribution
EA Credit:1 <b>Energy &amp; Atmosphere:</b> Optimize Energy Performance	2-10	Achieve increasing levels of energy performance above the prerequisite standard to reduce environmental impact associated with excessive energy use.	Demonstrate a percentage improvement in the proposed building performance rating compared to the baseline building performance rating per ASHRAE/IESNA Standard 90.1—2004	Coronado Stone Veneer products can add to the building energy efficiency of exterior walls. Overall efficiency contribution depends on architectural design.
MR Credit:4.1 or 4.2 <b>Materials &amp; Resources:</b> Recycled Content: 10% or Recycled Content: 20%	1-2	Increase demand for building products that incorporate recycled content materials, therefore reducing the impact resulting from extraction and processing of virgin materials.	Use materials with recycled content, such that the sum of post-consumer recycled content plus one-half of the pre-consumer content constitutes at least 20% (based on cost) of the total value of the materials in the project.	Coronado Stone Veneer products can contribute to a project's overall recycled content. Recycled material is used in the production of Coronado's stone veneer which may vary between facilities.
MR Credit:5.1 or 5.2 <b>Materials &amp; Resources:</b> Regional Materials: 10% or Regional Materials: 20%	1-2	Increase demand for building materials and products that are extracted and manufactured within the region, thereby supporting the use of indigenous resources and reducing the environmental impact resulting from transportation.	Use building materials or products that have been extracted, harvested or recovered, as well as manufactured within 500 miles of the project site for a minimum of 20% (based on cost) of the total materials value.	Coronado Stone has 6 strategically placed manufacturing facilities located in the U.S. & Canada which can provide a contribution to this category. (view map on page 84)



Coronado Stone Products is Proud to be a Member of the U.S. Green Building Council.



In 1960, there was only one stone manufactured in California. It was a 2½' x 4' sheet of concrete which was broken up into random shapes at the job site. Mel Bacon saw the need for something better and started making his own stone. He soon developed the first random shaped stones from individual molds which led to the development of many of today's popular varieties of ledge stones and ashlar patterns.

As a mason, Mel experienced the difficulty of installing stone that was not created with the installer in mind. It was heavy and the shapes and sizes were difficult to piece together. He realized that through proper pattern and mold design, ease of installation could be achieved. From that moment, ease of installation became the benchmark for every pattern of stone Mel created. Easy installation is not only a time saver, it's a project saver.

The pride we take in the creation of our product shows in the quality experience you will enjoy as one of our valued customers. Give Coronado the opportunity to make you a believer. Our mission is your satisfaction!

## OVER 50 YEARS OF MANUFACTURING EXCELLENCE

Coronado manufactures and distributes its high quality stone at five factories conveniently located across North America

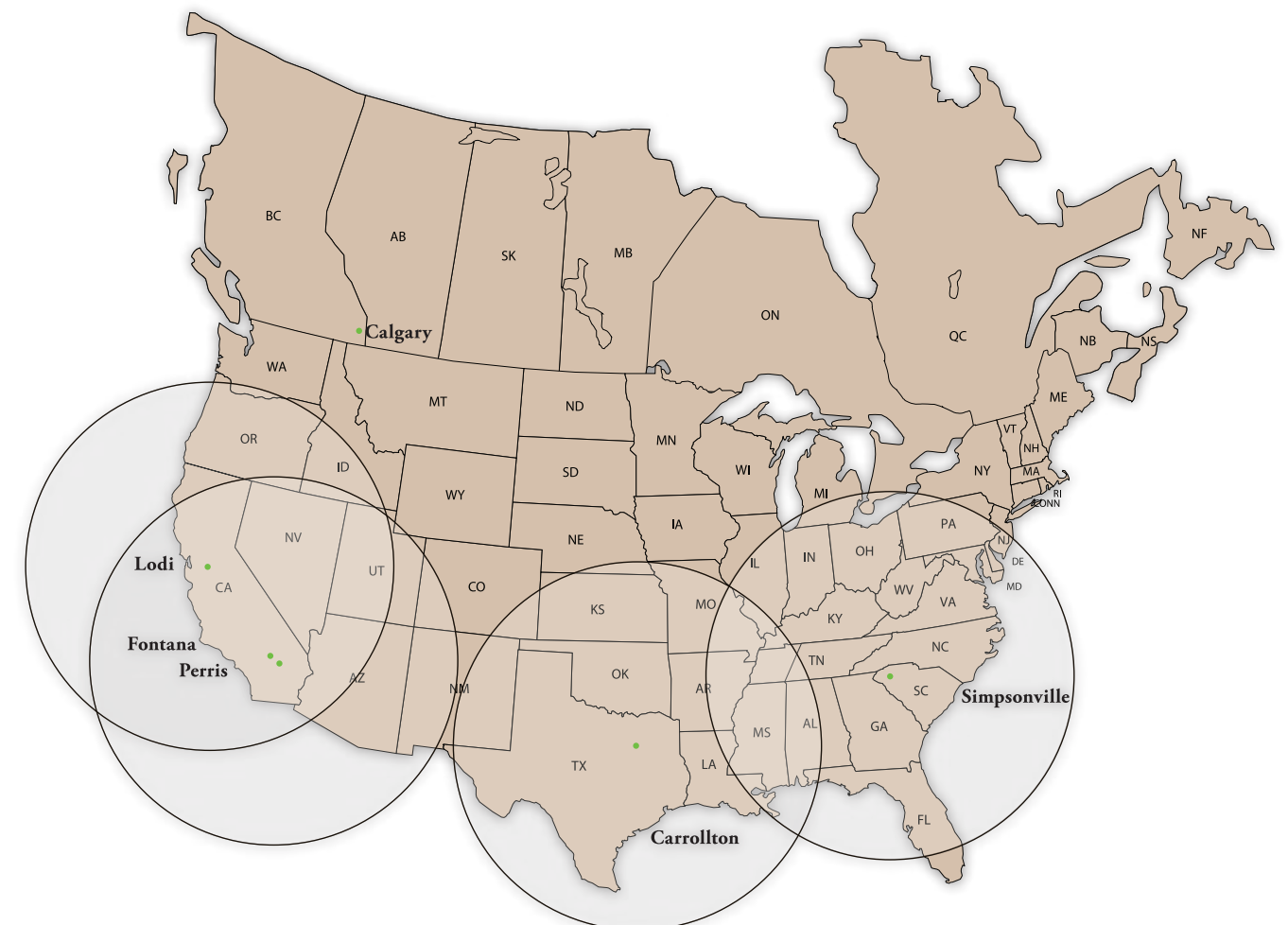

Circles above indicate 500 mile radius for LEED requirements.

Western Region serviced by the Fontana, Perris and Lodi factories  
**(800) 847-8663**

Western Canada Region serviced by the Calgary factory  
**(403) 203-0881**

Central Region serviced by the Carrollton factory  
**(888) 567-2833**

Eastern Region serviced by the Simpsonville factory  
**(864) 962-1221**



French Limestone with 4" Chiseled Limestone Band - *French White*

Five Dollars



**CORONADO**®

The Leader in Manufactured Stone, Brick and Tile Products

11191 Calabash Ave. • Fontana, CA 92337  
Phone: (800) 847-8663 Fax: (909) 357-7362  
sales@coronado.com

[WWW.CORONADO.COM](http://WWW.CORONADO.COM)

Due to photographic and printing variations, brochure colors may not be accurate. All sizes are nominal.  
We suggest examination of Coronado product samples prior to purchase.